

DIVUS KNX IQ 08

USER MANUAL - ENGLISH

based on image version 4.16

GENERAL INFORMATION

DIVUS GmbH
Pillhof 51
I-39057 Eppan (BZ)

Operating instructions, manuals and software are protected by copyright. All rights are reserved. Copying, multiplication, translation and conversion, either partially or as a whole, is not permitted. You are allowed to make a single copy for backup purposes.

We reserve the right to make changes to the manual without prior notification.

We assume no responsibility for any errors or omissions that may appear in this document.

We do not assume liability for the flawlessness and correctness of the programs and data contained on the delivered discs.

You are always welcome to inform us of errors or make suggestions for improving the program.

The present agreement also applies to special appendices to the manual.

This manual can contain terms and descriptions, which improper use by third can harm the copyrights of the author.

Please read the manual before beginning and keep the manual for later use.

The manual has been conceived and written for users who are experienced in the use of PCs and automation technology.



Our General Terms and Conditions apply, which can be downloaded here:

<https://www.divus.eu/en/general-conditions>

This version of the manual is based on the following version(s):

- KNX IQ image R4.16
- DIVUS IQ LAUNCHER v. 1.0 rev. 47
- DIVUS VISION v. 0.12.10 rev. 57
- DIVUS VIDEOPHONE 4 v. 4.2.4 rev. 160
- DIVUS KIBRO v. 1.4 rev. 1430
- DIVUS IP CAM VIEWER v. 1.1 rev. 26
- DIVUS SCREENCLEANER v. 2.0 rev. 13

CONVENTIONS

[KEYS]	Keys that are to be pressed by the user are given in square brackets, e.g. [CTRL] or [DEL]
COURIER	On-screen messages are given in the Courier font, e.g. c:\>
COURIER BOLD	Keyboard input to be made by the user are given in Courier bold, e.g. c:\>DIR .
"..."	Names of buttons to be pressed, menus or other onscreen elements and product names are given within double quotes. (e.g. "Configuration").
PICTOGRAMS	In this manual the following symbolic are used to indicate particular text blocs.
	Caution! A dangerous situation may arise that may cause damage to material.
	Hint Hints and additional notes
	New New features

The terms "DIVUS KNX IQ" and "DIVUS KIQ" or simply "KIQ" all point out the same product.

SAFETY INSTRUCTIONS

The present operating instructions contain those safety instructions that are required to safely operate the machine.

All persons working with the machine must heed the present operating instructions, especially the safety instructions.

In addition, all local stipulations governing the prevention of accidents must be heeded.

Only trained and authorized personnel may **INSTALL AND OPERATE** the machine.

PROPER APPLICATION: The machine has been designed for application inside the building automation and must not be used to control security functions.

The machine has been built using state-of-the-art technology and all applicable safety regulations. However, damage or negative effects to the machine or other material cannot be excluded if the machine is operated.

The machine meets the requirements of the EMC guidelines and of the harmonized European standards. Modifications to the machine hardware may affect the system's EMC compatibility.

Without special protection measures, the machine must not be used in EX areas and in plants that require special monitoring.

Danger of explosion. Do not expose the buffer batteries to heat. Serious injury may be the result.

The operating voltage of the machine must be within the specified range! The product label provides the required information.

The device is designed to be mounted at most 2m above the ground.



Electrical devices may only be mounted and connected by electrically skilled persons.

STANDARDS

The DIVUS KNX IQ meets the following guidelines and standards:

Low Voltage Directive 2014/35/EU (ex 73/23/CEE – 93/68/CEE – 06/95/CE)

Standard to which conformity is declared:

EN 50491-3:2009, EN 62368-1:2014/A11:2017

Safety

EMC Directive 2014/30/EU (ex 89/336/CEE – 92/31/CEE – 93/68/CEE – 04/108/CE)

Standard(s) to which conformity is declared:

EN 50491-5-1:2011, EN 50491-5-2:2011, EN 55032:2013, EN 55035:2017,

Draft ETSI 301 489-1 V2.2.0, Draft ETSI 301 489-17 V.3.2. Conducted & Radiated Emissions

RoHS2 Directive 2011/65/EU (ex 02/95/EC)

Standard(s) to which conformity is declared:

EN 50581:2012

Restriction of hazardous sub-

stances

The installation and wiring instructions contained in this documentation must be heeded. Conformity is indicated by the attached CE label.

The EC conformity statements can be obtained from:

DIVUS GmbH
Pillhof 51
I-39057 Eppan (BZ)



Regarding Directive 2012/19/EU (ex 2002/96/EC) waste electrical and electronic equipment has to be collected separately and is not allowed to dispose as unsorted municipal waste.

INDEX

1	PRODUCT DESCRIPTION	9
1.1	FRONT VIEW	9
1.2	CONNECTIONS	10
1.3	REAR CONNECTIONS	11
1.3.1	DIO (DIGITAL INPUT/OUTPUT)	12
1.3.2	DC IN	13
1.4	PRODUCT CONTENTS	14
2	COMMISSIONING	15
2.1	GROUNDING	15
2.2	COMMISSIONING	15
2.3	INSTALLATION	16
2.3.1	INSTALLING MOUNTING BOX	16
2.3.2	INSTALLING DIVUS KNX IQ	16
3	OPERATING SYSTEM	17
3.1	FEATURES	19
3.2	HARDWARE INTERFACES	19
3.2.1	PHYSICAL HOME BUTTON	20
4	DIVUS APPS	21
4.1	DIVUS IQ LAUNCHER	21
4.2	DIVUS VISION	22
4.3	DIVUS VIDEOPHONE 4	23
4.4	DIVUS KIBRO	24
4.5	DIVUS IP CAM VIEWER	25
4.6	DIVUS SCREENCLEANER	26
4.7	DIVUS SYNCHRONIZER	27

4.8	TEAMVIEWER QUICKSUPPORT	28
4.9	SYSTEM UPDATE	29
5	TECHNICAL DATA.....	30
5.1	MECHANICAL DATA.....	30
5.2	DATA OVERVIEW.....	31
5.3	MOUNT INSTRUCTIONS	33
5.4	MAINTENANCE AND UPKEEP	39
6	APPENDIX	40
6.1	RECYCLING INFORMATION.....	40

1 Product description

DIVUS KNX IQ is a high-quality glass multi-touch panel for building automation, ideal for both residential and commercial applications. The panel is a cost-effective entry solution and retro-compatible with many existing wall-mounting boxes. This stand-alone KNX device can be used for a wide range of applications, including but not limited to:

- Home automation system
- KNX visualization/control unit
- Security and surveillance
- Interior intercom station

DIVUS KNX IQ is the ideal stand-alone building automation entry panel *made in Italy*.

1.1 FRONT VIEW

DIVUS KNX IQ is available in black with a display size of 20,32 cm (8").



1.2 CONNECTIONS

When mounted only some of the interfaces are actually visible from the front, and only the down-facing HOME button at the bottom center is accessible. The connections are placed out as follows:

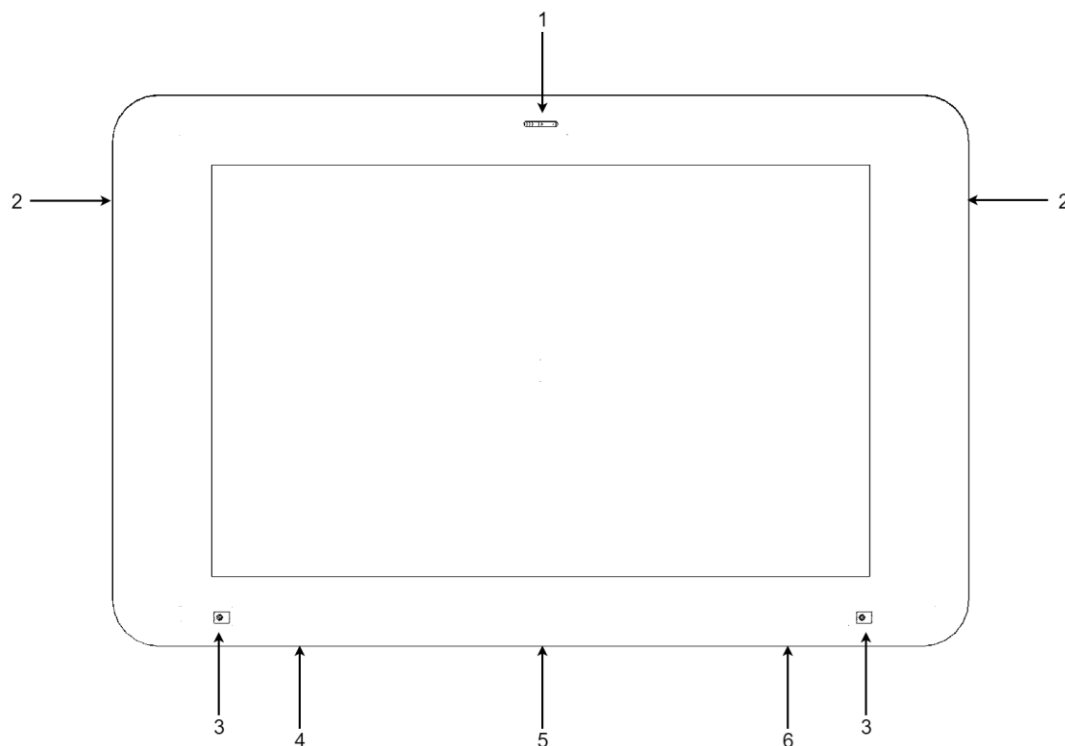

- 1) Proximity/brightness sensor
- 2) Speakers
- 3) Microphones
- 4) Digital temperature sensor
- 5) HOME button
- 6) USB OTG (not present on all devices)



The present connections may vary depending on your model!

1.3 REAR CONNECTIONS

DIVUS KNX IQ offers additional connections on the rear of the device, as can be seen in the following image:

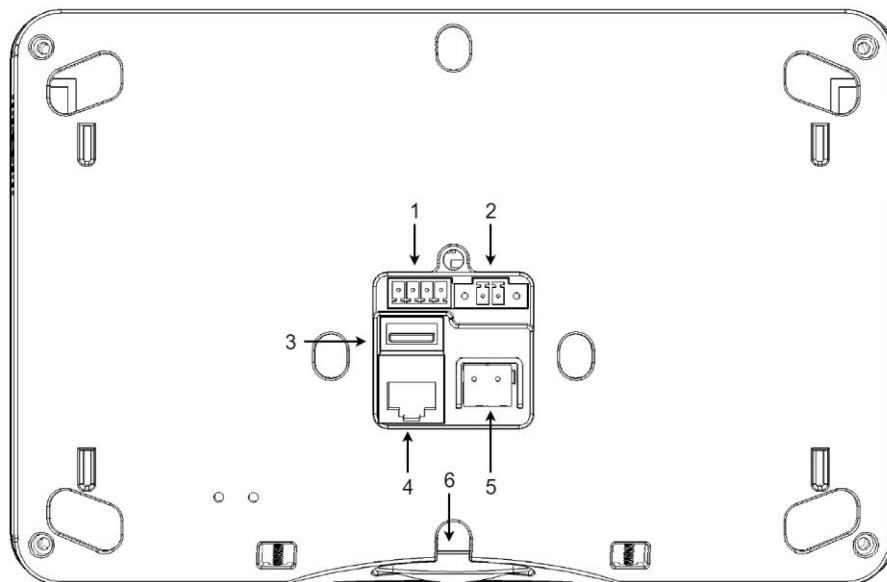

- 1) Digital input/output
- 2) DC in (12-36 VDC)
- 3) USB
- 4) LAN Cat5e/Cat6 UTP cable max. 100m
- 5) KNX connector (not present on all devices)
- 6) HOME button



The present connections may vary depending on your model!



The device does not support PoE+ and must be powered with DC in.

1.3.1 DIO (DIGITAL INPUT/OUTPUT)

DIVUS KNX IQ is equipped with a single digital input and single digital output, in order to interact with other systems. The DIO pin assignment is as follows:

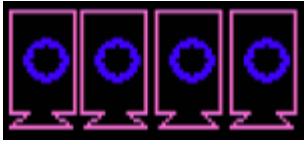
Pin no.	Signal	CN2
1	GND	
2	Digital input	
2	Digital output	
4	+5V	

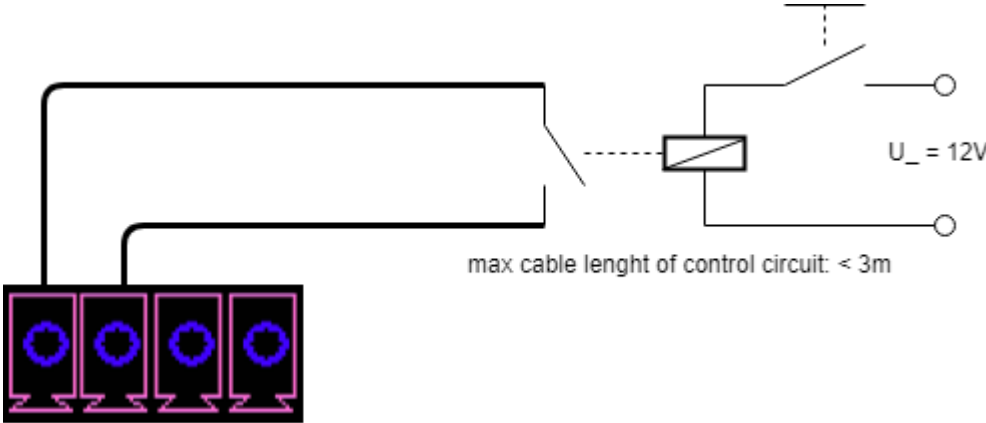

The digital output is of type open-collector with 5V power supply and max 0.13A output, which allows to directly connect corresponding relays.

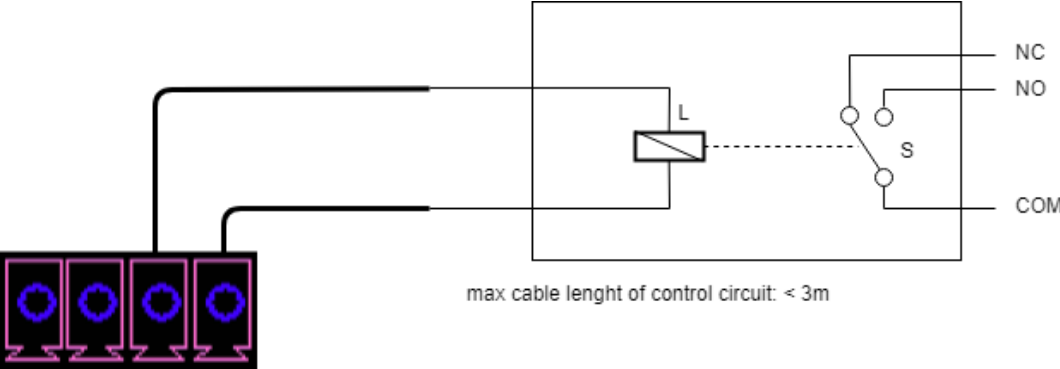

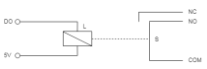
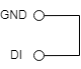
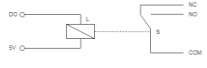
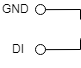
Voltage output HIGH (on)	<p>0 V</p> 	Voltage input HIGH (on)	<p>0 V</p> 
Voltage output LOW (off)	<p>5 V</p> 	Voltage input LOW (off)	<p>5 V</p> 
Output current (open-collector)	max. 0.13A		

1.3.2 DC IN

DC IN of the device is as follow:

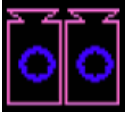
Pin no.	Signal	CN19
1	Vin +	
2	Vin -	

1.4 PRODUCT CONTENTS

Hardware:

- DIVUS KNX IQ
- Mounting adapter

Software:

- Pre-Installed, fully functional operating system

Documentation:

- Quick Start Guide
- Version overview

Available for download:

- Technical manual
- Warranty conditions

2 Commissioning

2.1 GROUNDING

The following must be heeded to ensure that all electrical interference is safely absorbed:

- Connect the metallic wall mount kit with a central grounding point using the shortest possible distance.
- Make sure that the connection between the unit and the grounding point has the lowest possible impedance.
- All data cables connected to the unit must be shielded.
- The shields must be grounded at both ends. A low-impedance connection must be established between the linked units. High compensation currents over the cable shields caused by potential differences must be excluded.
- Use a green-yellow cable with a minimum cross section of 2,5mm² for ground connection.

2.2 COMMISSIONING

The power supply of the DIVUS KNX IQ is provided through the DC input on DC in plug only. Using DC input, the used power supply needs to provide safety extra-low voltage (SELV) and has to be compliant to EN60950-1 par.2.5 and EN61558-2-6 or equivalent. The device must be powered through a supply providing max. 15 VA under normal operating conditions.

There must be means for disconnection incorporated in the fixed wiring. Have the appliance connected to the mains using a device that allows the appliance to be disconnected from the mains at all poles with a contact opening.

Power consumption of the device is defined in the technical documents.



Pull out the power plug before opening the unit. Check all cable connections before commissioning the system. Make sure that all voltages and signals meet the specifications.



The device does not support PoE+ and must be powered with DC in.



DIVUS offers a warranty of 24 months after shipment (valid from the date of delivery) if not stated otherwise for the DIVUS KNX IQ. The warranty is only valid if all transportation takes place with the original package of the product, including all shock absorbing elements.

Every repair shipment has to be approved by the technical support. Contact us under support@divus.eu. On that occasion you also get all necessary information, as well as the accompanying letter "repair request".

The original packaging has to be used for all transportations, including transportation back to the distributor or manufacturer in case of repair. Otherwise DIVUS can't give any guarantee for the product. Any damage occurring to the product if incorrectly packed will be charged to the client. Furthermore in such a case DIVUS will charge an additional fee for packing.

For repair processes the "repair request" document has to be compiled and returned with the product to allow us to guarantee an efficient service and a two week repair time.

For technical reasons only complete products can be returned for repair.

2.3 INSTALLATION

2.3.1 INSTALLING MOUNTING BOX

DIVUS KNX IQ is compatible with various mounting boxes. For instructions on how to install the mounting box refer to the corresponding manual/instructions for your used mounting box. Keep in mind to consider all required cables and corresponding access when installing the mounting box.

2.3.2 INSTALLING DIVUS KNX IQ

Switch off the system/plant supply voltage, then connect the power and controlling cables to the device. After this you can put the DIVUS KNX IQ in its mounting box and fix it with the screws and mounting plate included in the packaging.



Once mounted DIVUS KNX IQ stands out from the wall by 16mm.



Unauthorized changes or modifications to the DIVUS KNX IQ configuration may result in permanent damage to the system or its functionality. Only authorized trained personnel are allowed to make any modifications.



In order to be able to dissipate the heat produced by the equipment, it must be guaranteed that the temperature within the mounting box does not exceed **45°C**. Under normal conditions this is given with an ambient temperature of up to **30°C**. If these values are exceeded, additional cooling has to be provided.

The equipment must be installed vertically, i.e. the front plate must be in an angle of 90° to the base plate. Installation has to comply to HD 60364-4-41 or other national prescriptions.

3 Operating System

DIVUS KNX IQ is delivered with Android operating system version 6.0.1 (M). This operating system is used on a wide variety of smartphone and tablets and offers many capabilities and possibilities through its open source core and all the manufacturer-specific applications. General information about the Android operating system can be found under www.android.com.

Besides the standard applications which are by default part of the operating system (e.g. gallery, music, player, etc.), the following proprietary applications are installed by DIVUS:

- DIVUS IQ LAUNCHER
- DIVUS VISION
- DIVUS VIDEOPHONE 4
- DIVUS KIBRO
- DIVUS IP CAM VIEWER
- DIVUS SCREENCLEANER
- System-Update
- TEAMVIEWER QuickSupport



More details about the single applications can be found in the corresponding manuals.

The device offers a navigation bar at the bottom of the display, which should simplify the navigation on the device. Besides the HOME button, this navigation bar contains additional soft keys required for the navigation within the Android system as can be seen in the below screenshot:



The 7 keys within the navigation bar from left to right are:

- POWER
- VOLUME DOWN
- BACK
- HOME
- RECENTS
- VOLUME UP
- MENU

The POWER key opens up the power menu, which allows to safely turn off or reboot the DIVUS KNX IQ.

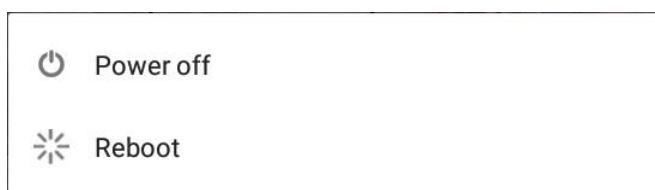

Always use this menu in order to shutdown the DIVUS KNX IQ! An abrupt removal of the power supply can interrupt running processes and cause the malfunction of different apps.

The VOLUME DOWN key lowers the volume of the DIVUS KNX IQ and shows the current volume through a corresponding slider element, which also offers additional audio controls.

The BACK key (depending on the shown app) allows to return to the previously shown page or to close the currently open app.

The HOME key has the same functionality as the hardware HOME button and brings you back to the main window of DIVUS IQ LAUNCHER. The previously active app is brought to the background and continues running (the HOME button/key does NOT terminate running apps).

The RECENTS key shows the recently opened apps, which allows a quick switching between different applications and – through swipe gesture – also gives the possibility to close apps.

The VOLUME UP key increases the volume of the DIVUS KNX IQ and – like the VOLUME DOWN key – shows the current volume through a corresponding slider element, which also offers additional audio controls.

The MENU key functionality depends on the currently shown app and – if available – shows additional menu and configuration options. The following screenshot shows an example of such a menu:



3.1 FEATURES

The pre-installed DIVUS apps provide the user with various functions to control the DIVUS KNX IQ and other external systems. These features include, among others:

- Customization and configuration of the DIVUS KNX IQ.
- Management of installed apps.
- Pre-installed DIVUS VISION app for building automation.
- Pre-installed DIVUS VIDEOPHONE 4 app for interaction with intercom systems.
- Pre-installed DIVUS KIBRO app for internet navigation.
- Pre-installed DIVUS IP CAM VIEWER app to visualize IP cameras.
- Pre-installed DIVUS SCREENSCLEANER app, used during screen cleaning.

In order to get the newest features be sure that your DIVUS KNX IQ has loaded the latest software version. An update for DIVUS KNX IQ to the latest operating system version can be requested using the following form:

<https://www.divus.eu/en/200-touchzone-softwareupdate-en>



The single apps can be installed/updated through the DIVUS SYNCHRONIZER tool. Additional information about DIVUS SYNCHRONIZER can be found in its dedicated manual.

3.2 HARDWARE INTERFACES

DIVUS KNX IQ offers different kinds of interfaces. Most interfaces are integrated and functional on Android level and can be accessed from custom applications through corresponding libraries. The following list shows the interfaces currently used by the applications of DIVUS:

- Proximity/brightness sensor: mainly used by DIVUS IQ LAUNCHER.
- Microphone: among others used by DIVUS VIDEOPHONE 4.
- Speaker: among others used by DIVUS VIDEOPHONE 4.
- KNX connection: used by DIVUS VISION.
- DIO: digital input/output, used by various DIVUS apps.
- USB: used to connect USB devices (e.g. USB storages, USB mouse).
- USB OTG: DIVUS KNX IQ can be used as mass storage on a PC.



Generally USB devices compatible with Linux operating systems that are using the default drivers (HID devices, mass storages) can be used in combination with DIVUS KNX IQ.



The present interfaces may vary depending on your model!

3.2.1 PHYSICAL HOME BUTTON

The device has a built-in physical HOME button, down-facing and located at the bottom center of the device. Besides opening the launcher application when pressed, the same way as the HOME button in the navigation bar, this physical HOME button has some additional functionalities. All available functionalities are as follows:

- Short press with display on: open launcher application (e.g. DIVUS IQ LAUNCHER).
- Short press with display off: turn display on.
- Long press (about 7s): turn device off.
- Short press while device is off: Turn on device.

4 DIVUS apps

4.1 DIVUS IQ LAUNCHER

The DIVUS IQ LAUNCHER app is the main app of DIVUS KNX IQ, which acts as the entry point of the device. The app provides access to the other functionalities and settings of the devices, and in its main screen it's possible to link to the pre-installed DIVUS applications. The overall look and feel can be customized and adapted to the required needs. DIVUS IQ LAUNCHER is the heart and soul of DIVUS KNX IQ.

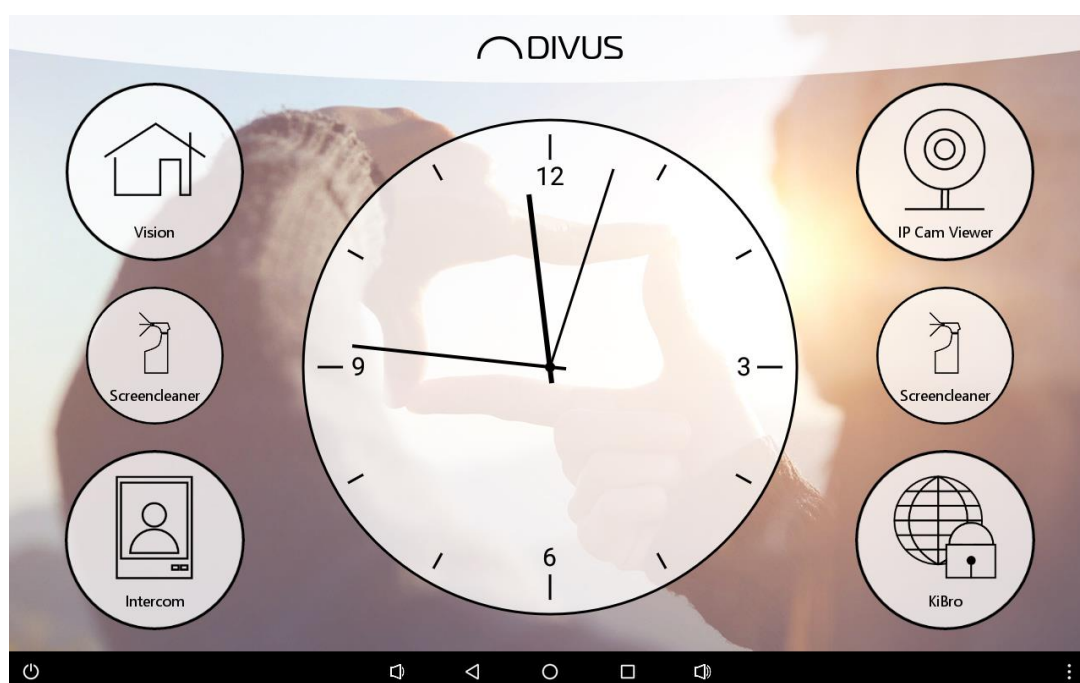

Detailed information about the app can be found in its dedicated manual which can be downloaded from our website www.divus.eu.



DIVUS IQ LAUNCHER is currently available only for DIVUS KNX IQ running Android 6.



DIVUS LAUNCHER 2 is not supported on DIVUS TOUCHZONE running Android 6.

4.2 DIVUS VISION

The DIVUS VISION app is designed to manage a KNX system through its customizable visualization. It directly access the KNX bus either through the built-in KNX interface or through the TCP/IP network using an external KNX/IP router, thus making DIVUS KNX IQ a stand-alone solution for your home automation. With DIVUS VISION you can control your building with the click of a finger.

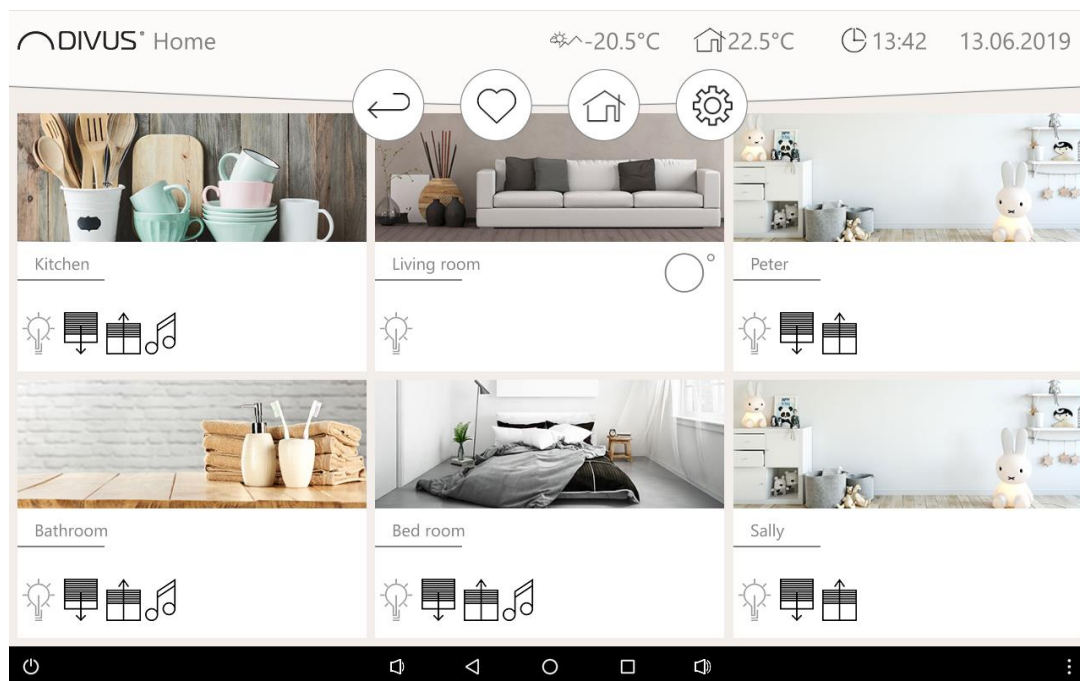

Detailed information about the app can be found in its dedicated manual which can be downloaded from our website www.divus.eu.

4.3 DIVUS VIDEOPHONE 4

DIVUS VIDEOPHONE 4 is the intercom app designed by DIVUS. It offers a vast set of useful functions and customization. Various internal and external units of the integrated phonebook can be customized, allowing also to be connected with multiple video signals. DIVUS VIDEOPHONE 4 is the ideal solution for intercom systems.

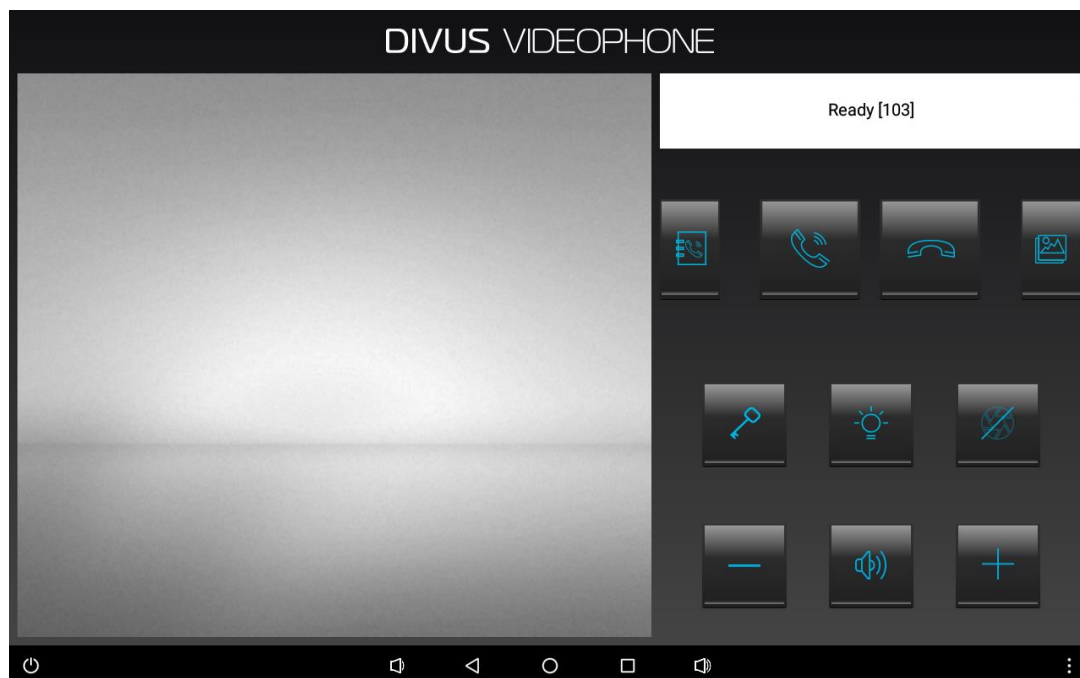

Detailed information about the app can be found in its dedicated manual which can be downloaded from our website www.divus.eu.

4.4 DIVUS KIBRO

DIVUS KIBRO is a kiosk browser app which allows to show web contents in full screen mode. This is the ideal app to access web-based systems for which no dedicated app exists. Its integrated cache and memory control routines will avoid that continuous data streams cause problems. DIVUS KIBRO allows easy internet navigation on your DIVUS KNX IQ.

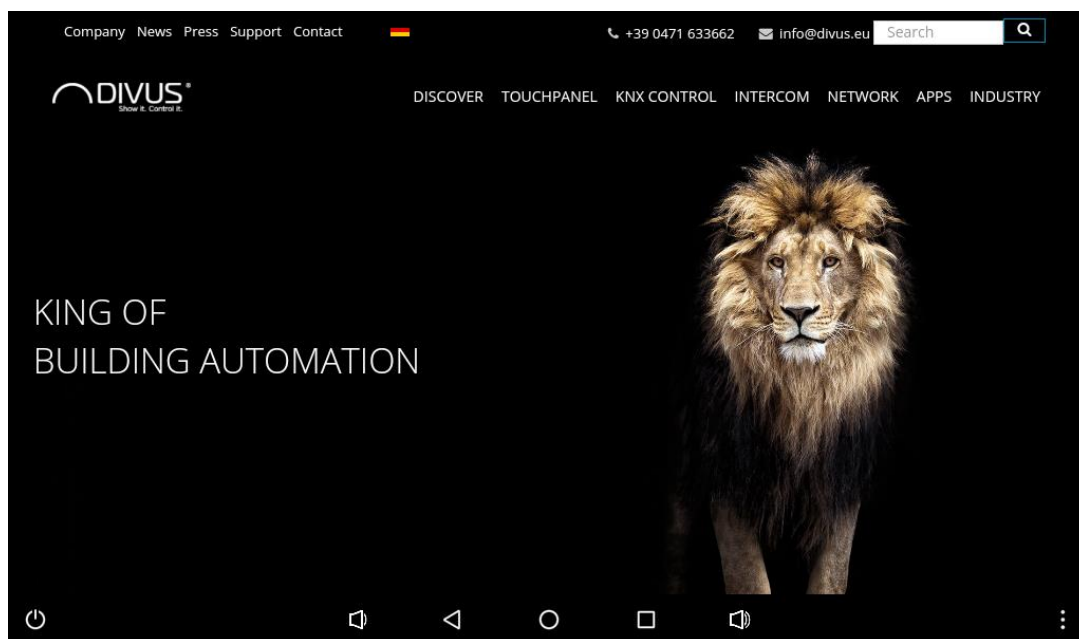

Detailed information about the app can be found in its dedicated manual which can be downloaded from our website www.divus.eu.



DIVUS KIBRO is available only for DIVUS TOUCHPANELS running Android.

4.5 DIVUS IP CAM VIEWER

With this app you have the possibility to access your IP cameras surrounding your home or your remote holiday resort, seeing in real-time what is happening around you, and help you feel more secure and in control. DIVUS IP CAM VIEWER allows you to easily connect local/remote IP cameras of various types and take screenshots of the current camera image. You can view up to 6 cameras simultaneously and by a simple click quickly see one in full screen. With the app DIVUS IP CAM VIEWER you can get the most out of your IP cameras and increase your surveillance capabilities; now you will always know what is happening around you.



Detailed information about the app can be found in its dedicated manual which can be downloaded from our website www.divus.eu.



DIVUS IP CAM VIEWER is available only for DIVUS TOUCHPANELS running Android 5 or higher.

4.6 DIVUS SCREENCLEANER

The functionality of DIVUS SCREENCLEANER is self-explaining and really simple: by starting this app, all touch inputs will be blocked for 30 seconds and a cleaning screen with a small animation is shown. Furthermore a countdown is shown, which indicates how much time is left for cleaning. While the app is running, the glass front of DIVUS KNX IQ can be cleaned without the risk of unwanted operation. Once the countdown reaches 0, the app will be closed automatically and the touch input is re-enabled. With DIVUS SCREENCLEANER it's possible to safely



clean the screen of DIVUS KNX IQ.



Further information about the DIVUS SCREENCLEANER app can be requested by contacting the technical support of DIVUS.

4.7 DIVUS SYNCHRONIZER

DIVUS SYNCHRONIZER is a tool for PC through which DIVUS Android devices can be easily managed. This tool connects to the device through the network, without the need to physically be at the device and without unmounting the device. It offers the possibility to create a backup and restore an existing device to a previous state, remote-control the device, facilitate configuration on the device through the use of keyboard and mouse, and much more! DIVUS SYNCHRONIZER offers you the possibility to work easier and faster, saving you time and

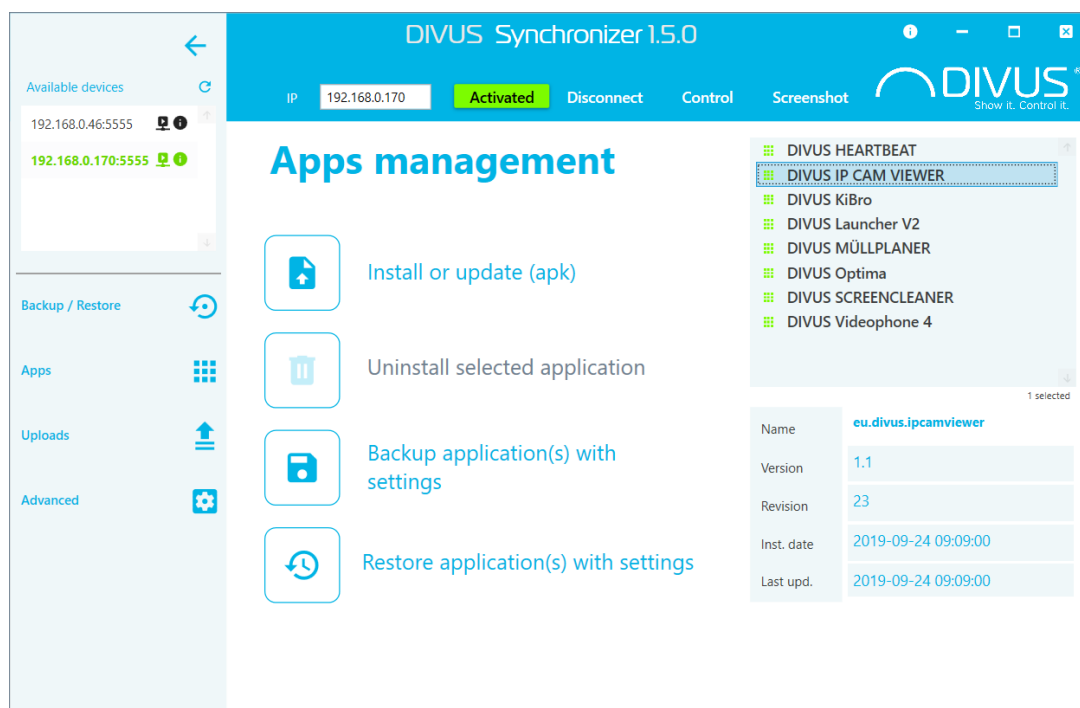

money.



Detailed information about the app can be found in its dedicated manual which can be downloaded from our website www.divus.eu.

4.8 TEAMVIEWER QUICKSUPPORT

DIVUS KNX IQ at delivery already contains the app "TeamViewer QuickSupport", which should simplify support cases, allowing the DIVUS personnel to connect remotely to the device (after authorization by the customer). Naturally this requires that DIVUS KNX IQ is correctly connected to internet.

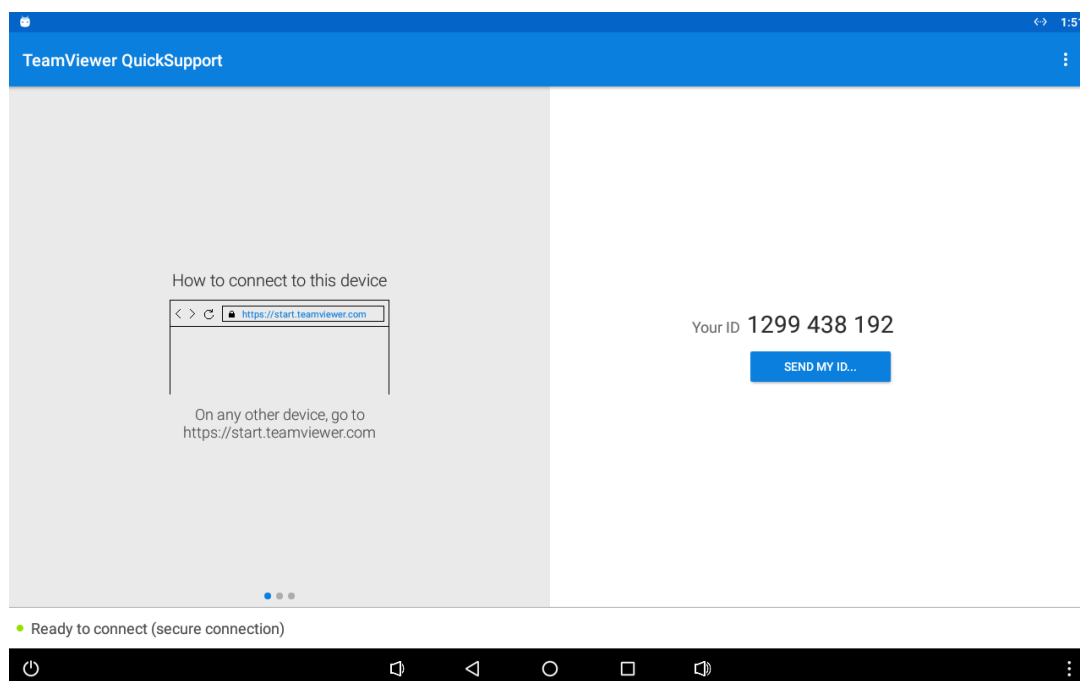

If the displayed ID is passed to the DIVUS personnel, a remote connection can be initiated and an efficient support can be given. Further information about the usage of "TeamViewer QuickSupport" can be found on www.teamviewer.com.



TeamViewer QuickSupport is started through the advanced settings screen of DIVUS IQ LAUNCHER, additional information can be found in the corresponding manual.

4.9 SYSTEM UPDATE

The “System Update” app is used to either update DIVUS KNX IQ to the latest version or to reset it to factory defaults (deleting all user data and settings).

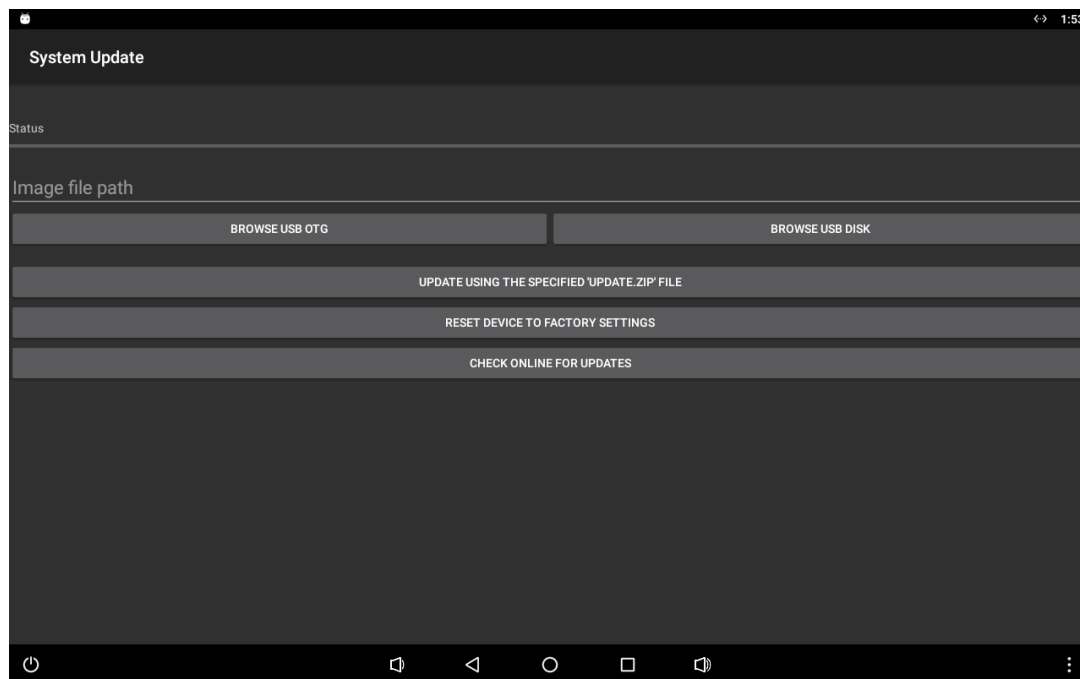

After Starting this app you can either update your DIVUS KNX IQ using a special file or you can reset the device to factory settings. By selecting the factory reset the device will automatically reboot, execute the reset and start with the factory defaults.

The update of the operating system is as easy: if DIVUS releases a new version, it happens through a so-called “Update.zip” file through an online repository. This update can be copied to a USB disk and can then be selected inside the System Update app.

The app also offers an OTA functionality (OTA = “over the air”) to get updates online from the DIVUS server. If your DIVUS KNX IQ is connected to the internet, simply click on the corresponding button: if a newer version is found on the DIVUS server, it is automatically offered for download. Afterwards the file is verified and – if confirmed by the user – automatically installed.



System Update is started through the advanced settings screen of DIVUS IQ LAUNCHER, additional information can be found in the corresponding manual.

5 Technical data

5.1 MECHANICAL DATA

Outside dimensions of DIVUS KNX IQ (landscape):

- Height (A): 145 mm
- Width (B): 225 mm
- Depth (C): 16 mm

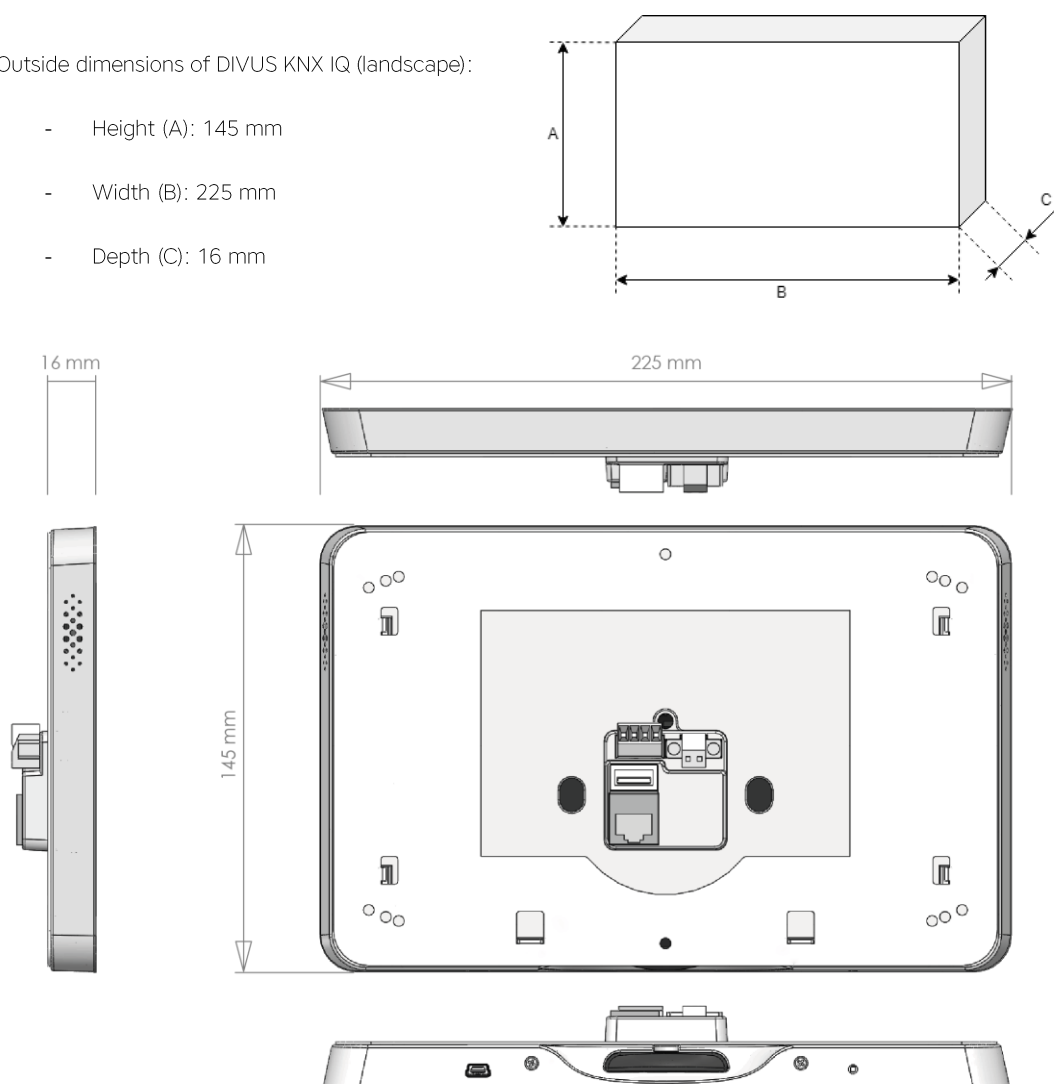

Regarding the dimensions of the mounting boxes consult the corresponding instructions and guidelines.

Fixing elements:

DIVUS KNX IQ has to be fixed to the wall mount box using the provided mounting adapter.

Mechanical characteristics:

PC Unit: glass front, plastic body, EMC proofed

5.2 DATA OVERVIEW

AVAILABLE Q3-2019	DIVUS KNX-IQ08-IP	DIVUS KNX-IQ08-TP
Type of design	DIVUS KNX-IQ08-IP BLACK - on wall mounted building touchpanel for visualization purposes; multitouch display and capacitive touch screen with optical bonding 20,32 cm - 8"; free DIVUS VISION, DIVUS IQ LAUNCHER, DIVUS VIDEOPHONE, DIVUS KIBRO, DIVUS IP CAM VIEWER and DIVUS SCREENCLEANER apps included	DIVUS KNX-IQ08-TP BLACK - on wall mounted building touchpanel with KNX interface for visualization purposes; multitouch display and capacitive touch screen with optical bonding 20,32 cm - 8"; free DIVUS VISION, DIVUS IQ LAUNCHER, DIVUS VIDEOPHONE, DIVUS KIBRO, DIVUS IP CAM VIEWER and DIVUS SCREENCLEANER apps included
VERSIONS		
With Black cover glass	design glass black	
SOFTWARE		
Operating System	Android operating system	
FRONT UNIT		
8,0" - 20,32 CM WIDESCREEN LED BACKLIGHT TFT WITH OPTICAL BONDING		
Luminosity	350 cd/m ²	
Contrast	800 : 1	
Resolution (in Pixel)	WXGA (1280x800)	
MTBF backlight	20.000 h	
Method of operating	projected capacitive touch screen with glass front, dual touch capable	
Rating	IP20 according EN 60529	
GENERAL CHARACTERISTICS		
Processor	fanless ultra low consumption Cortex-A53 Quad Core 1,5GHz	
Memory	2 GB	
Free expansion slots	-	
Power supply	12-32 VDC	
Power consumption without peripherals	max. 16 W	
Warranty	24 Months*	
DRIVES		
Storage medium	high speed Flash Memory 16GB eMMC (available disk space tbd)	
SENSORS		
Proximity sensor	integrated	
G Sensor for orientation	integrated	
Brightness Sensor	integrated	
MULTIMEDIA		
Input/output	2 x 1.5 Watt loudspeaker 2 x digital microphone	
Functionality	integrated Echo cancellation for bi-directional interphone communication	
INTERFACES		
LAN/Ethernet	1 x GbE on RJ45	
USB (Universal Serial Bus)	1 x USB 2.0 - USB OTG (1x ext)	
Digital Input/Output	GPIO - 1 x input / 1 x output for 1 relays with max. 100 mA/5VDC for use with DIVUS VIDEOPHONE only	
Battery	battery free system - RTC with capacitor backup	
KNX	KNX IP-Router/Interface required	KNX on board - Twisted Pair (TP) - connector included

AVAILABLE Q3-2019	DIVUS KNX-IQ08-IP	DIVUS KNX-IQ08-TP
SURVEILLANCE		
Home button	1 x home button / reset	
AMBIENT CONDITIONS		
EMC	EN 55011, 55022, 500081	
Temperature	+0°C to +30°C max.	
Relative humidity	5% to 80% at 25°C (no humidity/condense)	
Authorization	CE	
DIMENSIONS		
Outside dimension [mm]	225 x 145 - depth outside the wall only 16 mm (including mounting adapter)	
Weight	1,0 kg	
MECHANICAL CHARACTERISTICS		
Mounting	Fast and easy one man mounting system with wall mount boxes Compatible with various mounting boxes: - Kaiser round box German standard 1555-04: 60 x 60 x 66 mm - DIVUS TOUCHZONE box MTZ07: 129 x 210 x 75 mm - Schneider Electric U.Motion box MTN6270-5001: 129 x 210 x 75 mm - Merten U.Motion box MEG6270-5001: 129 x 210 x 75 mm - Feller Home-Panel box Agro 9926.90: 195 x 140 x 56 mm - Italian Standard box type 503: 96 x 59 x 49,8 - ABB MT701 devices: retrofit for MT701 mounting boxes UP-KAST2: 212 x 124 x 75 mm	
PC Unit	EMC proofed	

**warranty ex works, normally 24 months, fixed at order. All data refer on print date, errors and changes excepted.
 NOTE: Internal connections are intended as inside the box unit, normally on pin header, external ones as outside the box. Nevertheless, once mounted in the wall, only connections described as "front accessible" will be reachable for the customer.*

5.3 MOUNT INSTRUCTIONS

KNX IQ

DIVUS KNX-IQ08 mounting GUIDE for

- ABB MT701 devices
- GIRA MT701 devices
- BERKER MT701 devices
- JUNG EBG24 devices mounting boxes UP-KAST

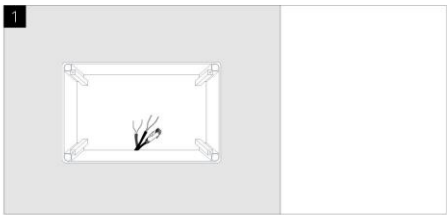

See the technical datasheet of the box for mounting instructions

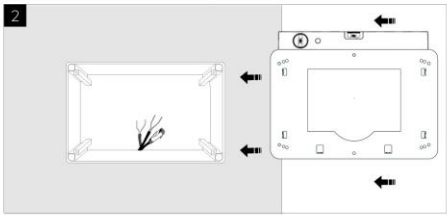

Place the metal gasket on the mounting box - make sure that it is horizontal. The 4 brackets look in your direction.

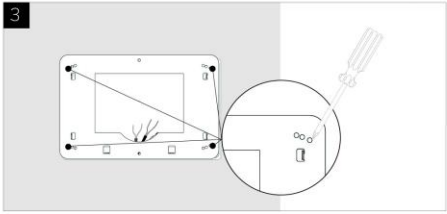

Fix the metal gasket with 4 countersunk screws (not part of the delivery)

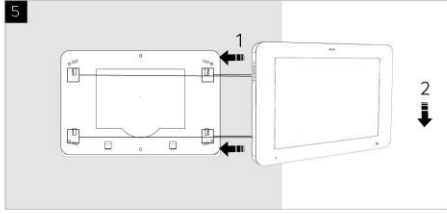
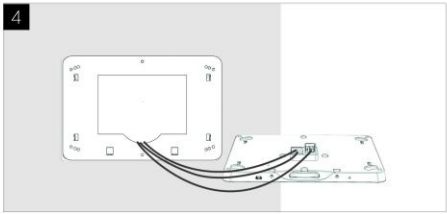

Insert the panel into the mounting brackets

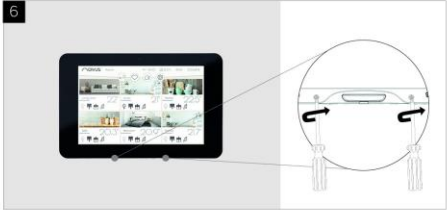

Fix the panel to the metal gasket with 2 screws

KNX IQ

DIVUS KNX-IQ08 mounting GUIDE for

- DIVUS TOUCHZONE box MTZ07

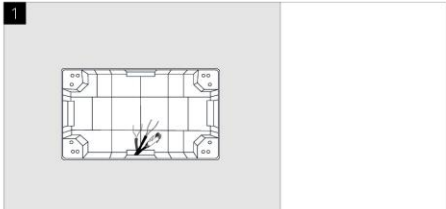
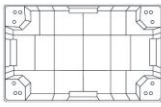

See the technical datasheet of the box for mounting instructions

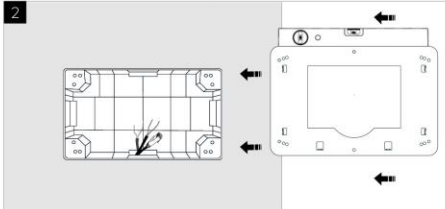

Place the metal gasket on the mounting box - make sure that it is horizontal. The 4 brackets look in your direction.

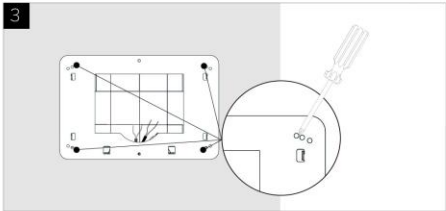

Fix the metal gasket with 4 countersunk screws (not part of the delivery)

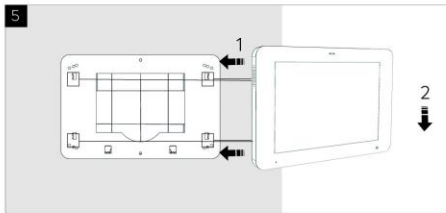
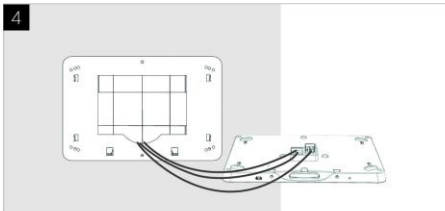

Insert the panel into the mounting brackets

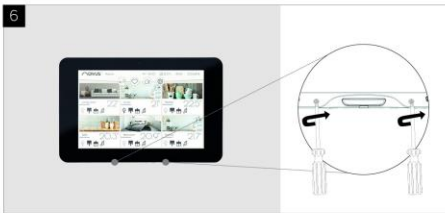

Fix the panel to the metal gasket with 2 screws

KNX IQ

DIVUS KNX-IQ08 mounting GUIDE for

- Feller Home-Panel box Agro 9926.90

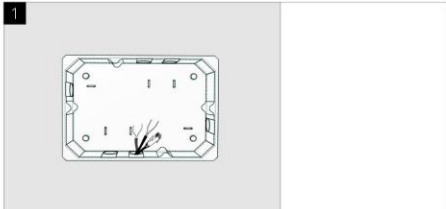

See the technical datasheet of the box for mounting instructions

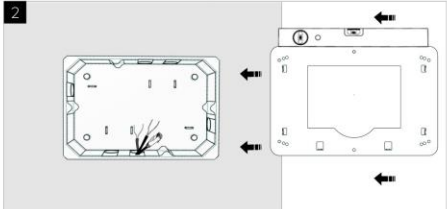

Place the metal gasket on the mounting box - make sure that it is horizontal. The 4 brackets look in your direction.

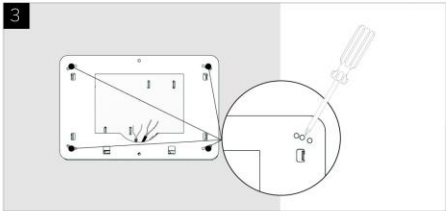

Fix the metal gasket with 4 countersunk screws (not part of the delivery)

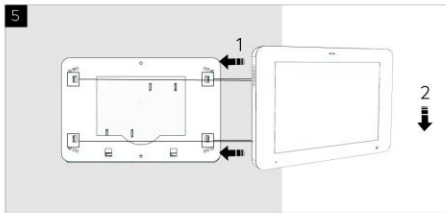
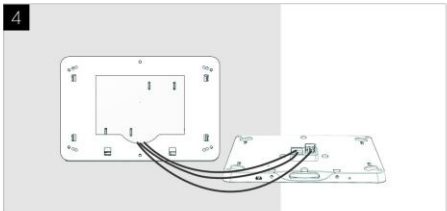

Insert the panel into the mounting brackets

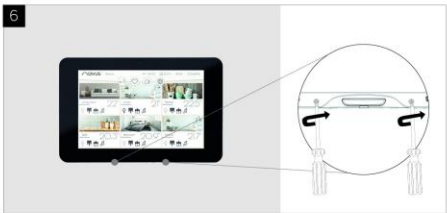

Fix the panel to the metal gasket with 2 screws

KNX IQ

DIVUS KNX-IQ08 mounting GUIDE for

- Italian standard box type 503



See the technical datasheet of the box for mounting instructions

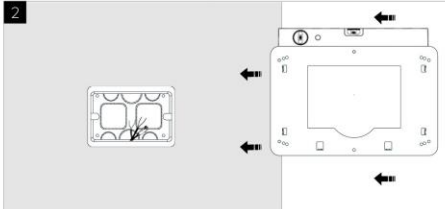

Place the metal gasket on the mounting box - make sure that it is horizontal. The 4 brackets look in your direction.

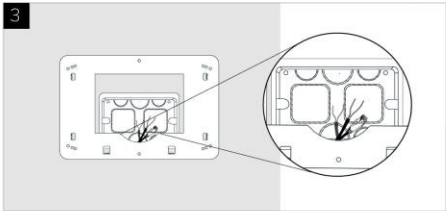

Fix the metal gasket with 4 countersunk screws (not part of the delivery)

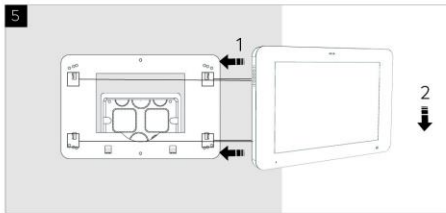
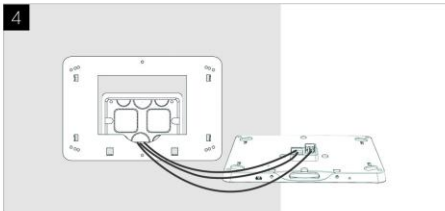

Insert the panel into the mounting brackets

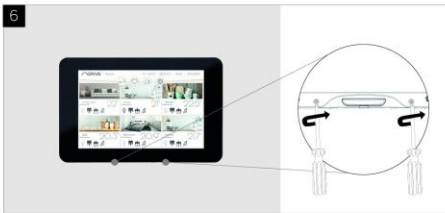

Fix the panel to the metal gasket with 2 screws

KNX IQ

DIVUS KNX-IQ08 mounting GUIDE for

- KAISER round box German standard 1555-04

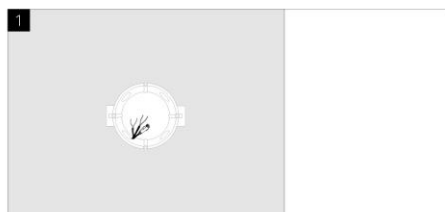

See the technical datasheet of the box for mounting instructions

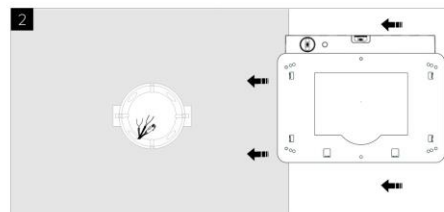

Place the metal gasket on the mounting box - make sure that it is horizontal. The 4 brackets look in your direction.

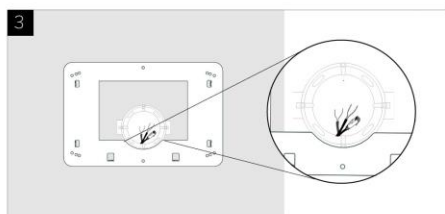

Fix the metal gasket with 4 countersunk screws (not part of the delivery)

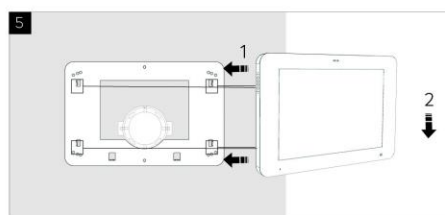
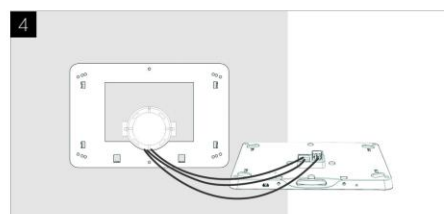

Insert the panel into the mounting brackets

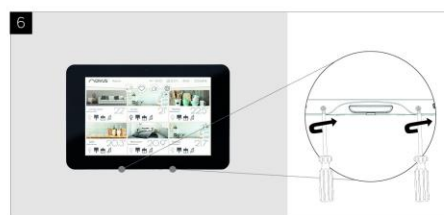

Fix the panel to the metal gasket with 2 screws

KNX IQ

DIVUS KNX-IQ08 mounting GUIDE for

- Schneider Electric U.Motion box MTN6270-5001
- Merten U.Motion box MEG6270-5001

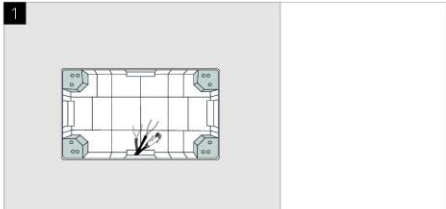

See the technical datasheet of the box for mounting instructions

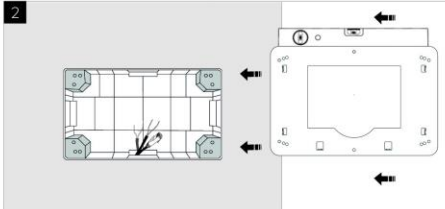

Place the metal gasket on the mounting box - make sure that it is horizontal. The 4 brackets look in your direction.

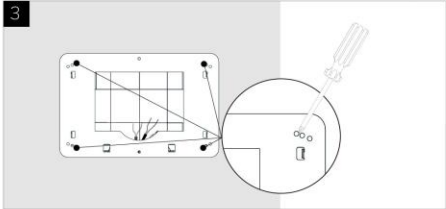

Fix the metal gasket with 4 countersunk screws (not part of the delivery)

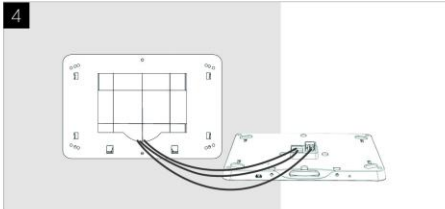

Fix the metal plate to the metal gasket with 2 screws

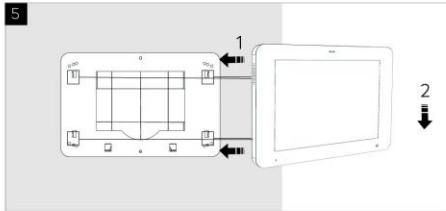

Insert the panel into the mounting brackets

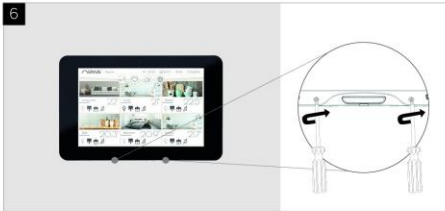

Fix the panel to the metal gasket with 2 screws

5.4 MAINTENANCE AND UPKEEP

DIVUS KNX IQ is a completely fanless system thus strongly reducing the necessary maintenance expenses.



NOTE: Additional information about the components which are used in DIVUS KNX IQ may be found in the original documentation of the manufacturer.

6 Appendix

6.1 RECYCLING INFORMATION



English

Information on Disposal of Old Electrical and Electronic Equipment (applicable for EU countries that have adopted separate waste collection systems)

Products with the symbol (crossed-out wheeled bin) cannot be disposed as household waste.

Old electrical and electronic equipment should be recycled at a facility capable of handling these items and their waste by products. Contact your local authority for details in locating a recycle facility nearest to you. Proper recycling and waste disposal will help conserve resources whilst preventing detrimental effects on our health and the environment.

Deutsch

Entsorgung von gebrauchten Elektrischen und Elektronischen Geräten (anzuwenden in den Ländern der Europäischen Union und anderen europäischen Ländern mit einem separaten Sammelsystem für solche Geräte)

Das Symbol (durchgestrichene Mülltonne) auf dem Produkt oder seiner Verpackung weist darauf hin, dass dieses Produkt nicht als normaler Haushaltsabfall behandelt werden darf, sondern an einer Annahmestelle für das Recycling von elektrischen und elektronischen Geräten abgegeben werden muss. Durch Ihren Beitrag zur korrekten Entsorgung dieses Produktes schützen Sie die Umwelt und die Gesundheit Ihrer Mitmenschen. Unsachgemäße oder falsche Entsorgung gefährden Umwelt und Gesundheit. Weitere Informationen über das Recycling dieses Produktes erhalten Sie von Ihrer Gemeinde oder den kommunalen Entsorgungsbetrieben.

Italiano

Informazioni sullo smaltimento delle vecchie apparecchiature elettriche ed elettroniche (valido per i paesi europei che hanno adottato sistemi di raccolta separata)

I prodotti recanti il simbolo di un contenitore di spazzatura su ruote barrato non possono essere smaltiti insieme ai normali rifiuti di casa. I vecchi prodotti elettrici ed elettronici devono essere riciclati presso un'apposita struttura in grado di trattare questi prodotti e di smaltirne i loro componenti. Per conoscere dove e come recapitare tali prodotti nel luogo a voi più vicino, contattare l'apposito ufficio comunale. Un appropriato riciclo e smaltimento aiuta a conservare la natura e a prevenire effetti nocivi alla salute e all'ambiente.

Français

Information sur l'élimination des anciens équipements électriques et électroniques (applicable dans les pays de l'Union Européenne qui ont adopté des systèmes de collecte sélective)

Les produits sur lesquels le pictogramme (poubelle barrée) est apposé ne peuvent pas être éliminés comme ordures ménagères. Les anciens équipements électriques et électroniques doivent être recyclés sur des sites capables de trier ces produits et leurs déchets. Contactez vos autorités locales pour connaître le site de recyclage le plus proche. Un recyclage adapté et l'élimination des déchets aideront à conserver les ressources et à nous préserver des leurs effets nocifs sur notre santé et sur l'environnement.

Nederlands

Informatie over het weggooien van elektrische en elektronische apparatuur (particulieren)

Dit symbool geeft aan dat gebruikte elektrische en elektronische producten niet bij het normale huishoudelijke afval mogen. Lever deze producten in bij de aangewezen inzamelingspunten, waar ze gratis worden geaccepteerd en op de juiste manier worden verwerkt, teruggewonnen en hergebruikt. Voor inleveradressen zie www.nvmp.nl, www.ictmilieu.nl, www.stibat.nl. Wanneer u dit product op de juiste manier als afval inlevert, spaart u waardevolle hulpbronnen en voorkomt u potentiële negatieve gevolgen voor de volksgezondheid en het milieu, die anders kunnen ontstaan door een onjuiste verwerking van afval.

Espanol

Información acerca de la eliminación de equipos eléctricos y electrónicos al final de la vida útil (aplicable a los países de la Union Europea que hayan adoptado sistemas independientes de recogida de residuos)

Los productos con el símbolo de un contenedor con ruedas tachado no podrán ser desechados como residuos domésticos. Los equipos eléctricos y electrónicos al final de la vida útil, deberán ser reciclados en instalaciones que puedan dar el tratamiento adecuado a estos productos y a sus subproductos residuales correspondientes. Póngase en contacto con su administración local para obtener información sobre el punto de recogida más cercano. Un iralamienlo corredo del redclaje y la eliminación de residuos ayuda a conservar los recursos y evita al mismo tiempo efectos perjudiciales en la sai ud y el medio ambiente.